

PROFORT X'TEND operating instructions, ref: 02272/750

Product compliant with standard NF P 93-353 of December 2009

3 --> 4 --> 5	0.7--> 0.93 --> 1.16	1.28-->1.47-->1.65	0.78-->1.57-->1.57	20.5	1.36x0.49x0.76	150Kg

1. Product description

This individual mobile platform for individual use is designed for finishing and equipment fitting work. The platform can be used by just one operator working on the ground.

It is fitted with two non-swivel rollers used for positioning it.

It is equipped with two independent adjustable stabilizers for use in 4 and 5 step versions. The stabilizers hold the unit perfectly securely under the normal operating conditions recommended by the standard.

2. Use

2.1. Assembly



Undo the velcro fastener and unfold the platform by lowering it

Take hold of the two guardrail tubes

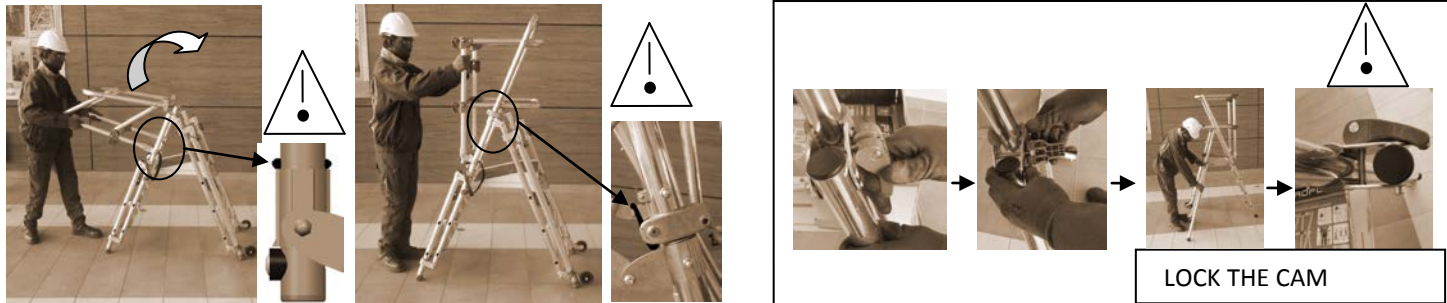

Put the guardrail in place by pivoting it

THE PIN MUST BE 'OUT'

THE LOCK MUST BE CLOSED

LOCK THE CAM

The stabilizer is put in place by unlocking the cam. It is in place once it makes contact with the floor. The cam must then be locked in position before the unit can be used.



Unlock the hook with your right hand. Take hold of the platform with your left hand and raise so that the hook is lowered below the bottom step.

Adjust the size of the unit step by step.

PROFORT X'TEND operating instructions, ref: 02272/750

2.2. Access

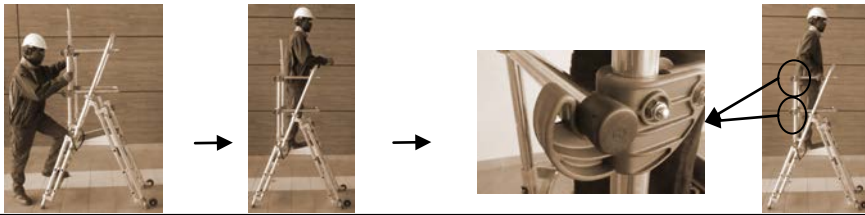

CLIP THE GATE INTO ITS HOLDER.

Open the gate to reach the work-floor. Once you are in position, the gate must be closed for working under correct conditions.

2.3. Moving



Moving when unfolded



Moving when folded

2.4. Work positions



2.4. Closing

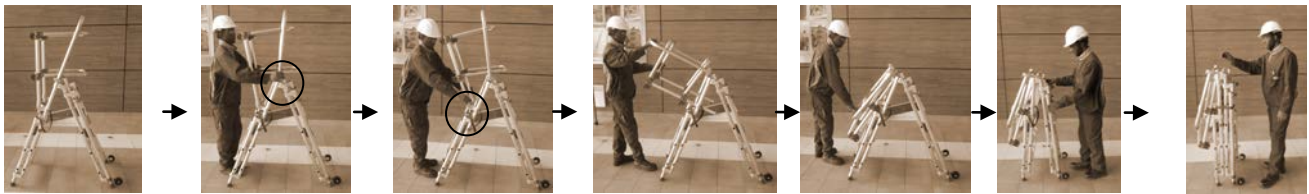

To fold up the telescopic section, carry out the assembling operations in the reverse order

2.6. Tool-holder, option ref.: 02272/526



2 possible positions



Unscrew the nuts



Put the tool-holder in place



Put the hooks in place and tighten the knobs



Tighten the knobs firmly

3. Recommendations for use:

- + Do not use the platform without its guardrails, nor behind any door that has not been locked.
- + The platform must only be used on horizontal, non-slip surfaces.
- + All the platform's feet must be in contact with the floor or ground.
- + On soft ground, a support plate must be placed under every foot.
- + Make sure that the work area is away from any bare conductor under power.
- + The platform must not be thrown or handled brutally when in use.
- + Always face the platform when climbing or coming down from it.
- + Make sure that you are wearing shoes that give you a firm footing.
- + Do not climb up the ladder if you suffer from vertigo or are tired.
- + Do not use the ladder without putting the stabilizers in place

4. Maintenance:

- + Systematically check that the platform is in a good general condition before use (condition of parts and their geometry. Should parts need to be replaced only use TUBESCA-COMABI components, see constructor after-sales service instructions)
- + After use on a site, wipe the ladder with a clean cloth.
- + The ladder must be regularly checked and results of the check must be recorded.